

General Set Up Instructions **Set up one frame at a time to avoid mixing pieces*

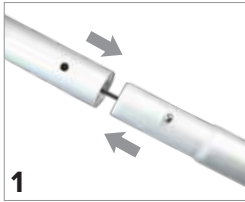

1
Straighten and connect all bungeed poles.

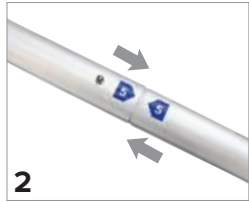

2
Organize all remaining poles by their numerical order & connect accordingly. **Insert any remaining reinforcement poles.**

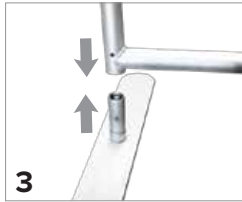

3
Lift the frame and connect the footplates onto the frame.



4
Put on your fabric gloves and slide the printed graphic over the frame.



5
Zip up to close the cover.

Side Shelf

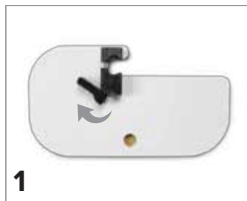

1
Start by loosening the latch on the bottom side of the shelf.



2
Connect shelf poles to the footplate. Then insert the shelf top into the pole and close the latch.



1
Snap the TV Mount into place between the tension walls/banners. Then, slide the X piece out.

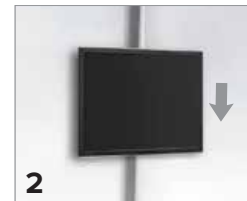

2
Screw X piece onto the back of your TV. Then secure the TV into the mount by sliding it into place until it clicks.

Case-2-Counter



1
Insert all four poles into the bottom case lid.

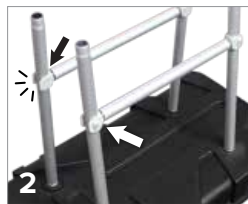

2
Connect the crossbars to the four poles by snapping them together.



3
Then, insert the top case into the four poles.



4
Pull the printed graphic over the frame. Then, buckle the two straps on the top & bottom.



5
Place top lid to cover the storage area and you're all set.

Light



1
Attach metal clamp on top of wall/banner and tighten. Then, slide light onto clamp.



2
Ensure the light is switched off before attaching cord and plugging into outlet.

Quick-N-Fit Booth 1205

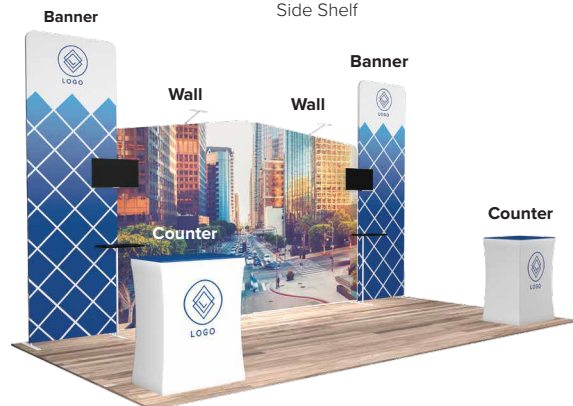
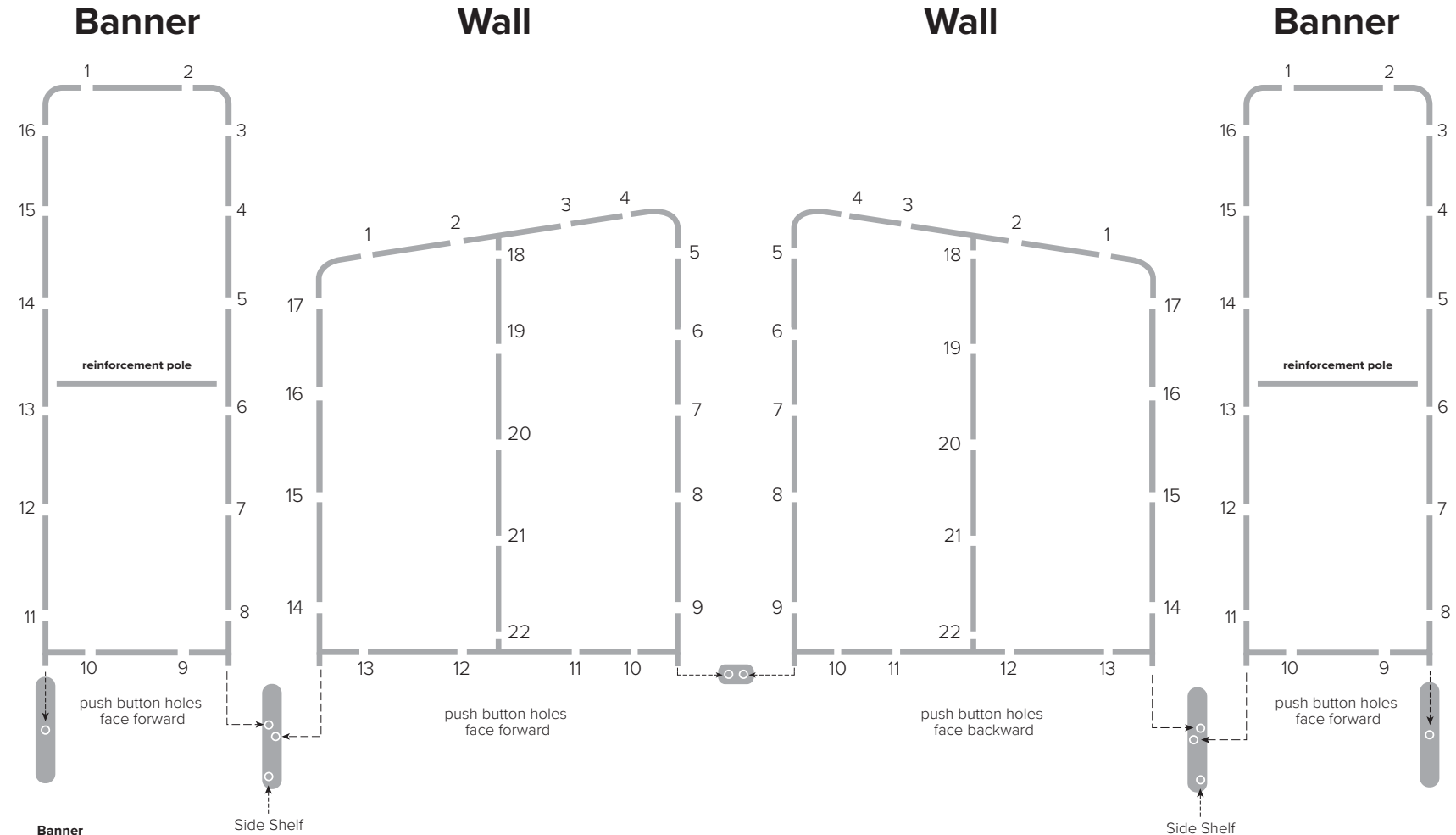

Includes:

- 2 Walls
- 2 Banners
- 2 Case-2-Counters
- 2 Side Shelves
- 2 TV Mounts
- 2 Lights

**TV & Flooring Not Included*