

# General Set Up Instructions *\*Set up one frame at a time to avoid mixing pieces*

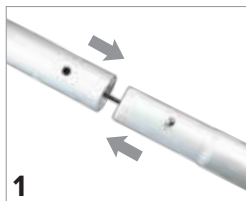

1  
Straighten and connect all bungeed poles.

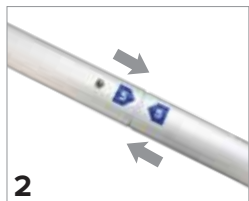

2  
Organize all remaining poles by their numerical order & connect accordingly. **Insert any remaining reinforcement poles.**

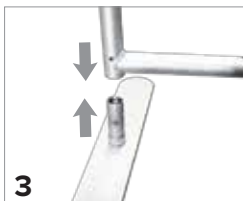

3  
Lift the frame and connect the footplates onto the frame.



4  
Put on your fabric gloves and slide the printed graphic over the frame.



5  
Zip up to close the cover.

## Light



1  
Attach metal clamp on top of wall/banner and tighten. Then, slide light onto clamp.



2  
Ensure the light is switched off before attaching cord and plugging into outlet.

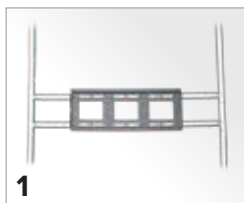

1  
After assembling the shelving unit for the TV, place the mount on top of the two support bars and screw into place.



2  
Screw mount base into the arch frame. Then, screw the mount arms onto the back of your TV.



3  
Secure your TV to the mount by hooking the arms onto mount, and tightening screws.

## Case-2-Counter



1  
Insert all four poles into the bottom case lid.

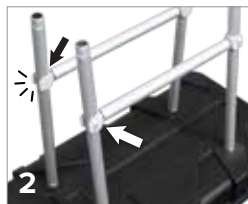

2  
Connect the crossbars to the four poles by snapping them together.



3  
Then, insert the top case into the four poles.



4  
Pull the printed graphic over the frame. Then, buckle the two straps on the top & bottom.



5  
Place top lid to cover the storage area and you're all set.

# Quick-N-Fit Booth 1220

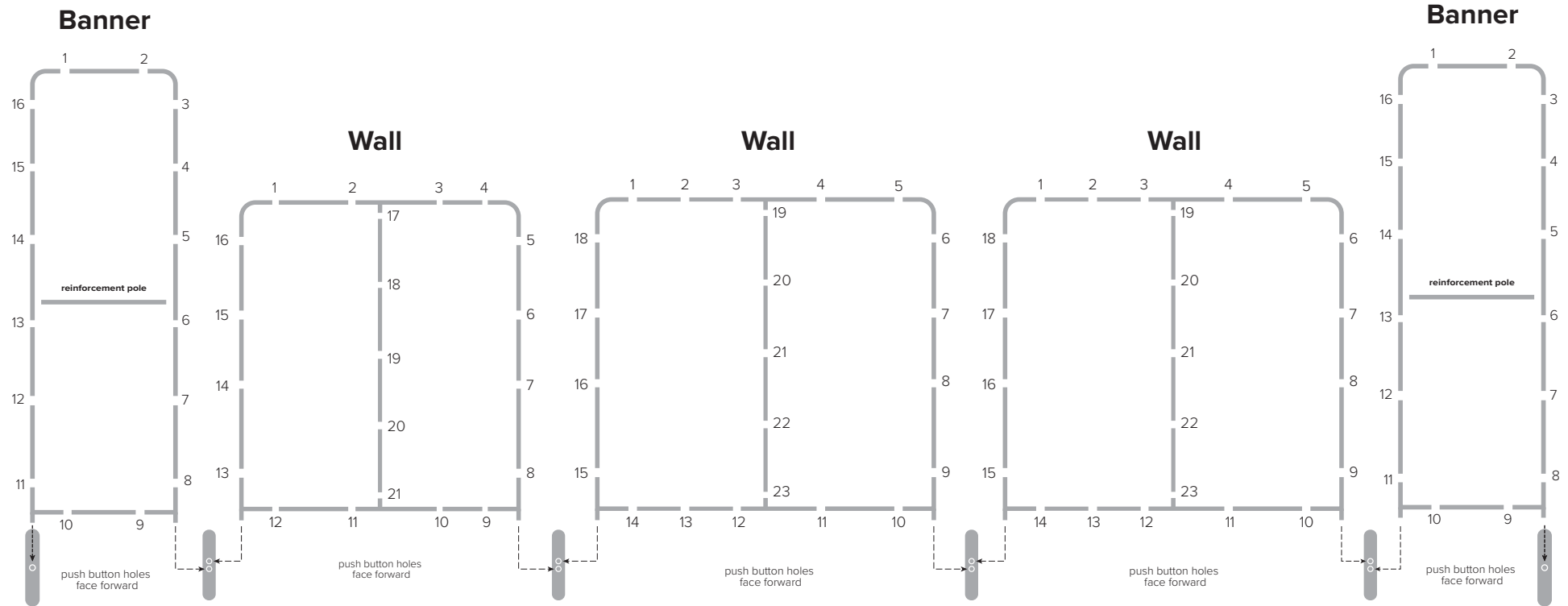

## Includes:

- 3 Walls
- 2 Banners
- 6 Shelves
- 2 TV Mounts
- 2 Lights

*\*TV & Flooring Not Included*